

# MORGAN TOWNSHIP SECTION 24 TWP 10 R 12 MORGAN COUNTY, OHIO

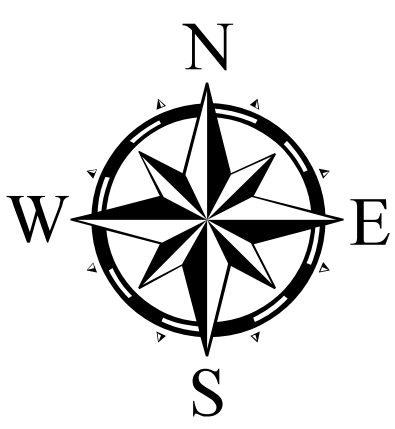

## S M I T H S S U B

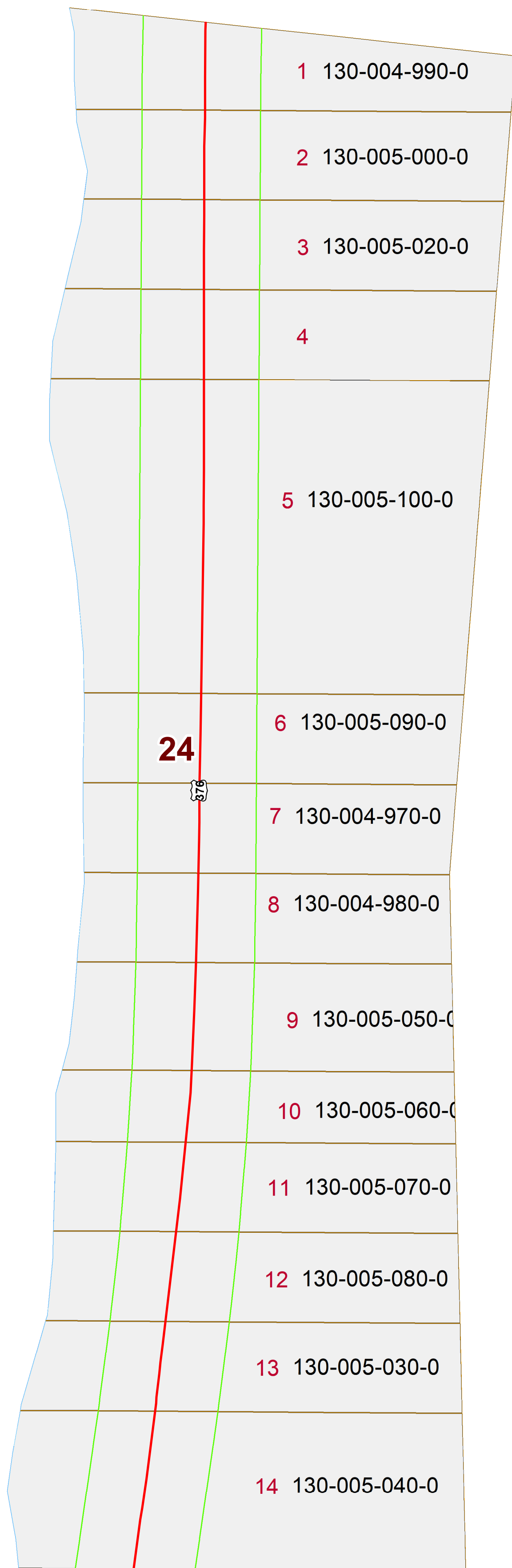

PIN	ListedName	LegalDescr	Acres	VOL	PAGE
130-005-040-0	WEBB RONALD L & LURA F	SMITH'S SD IN LOT 14	0	OR209	1922
130-005-030-0	WEBB RONALD L & LURA F	SMITH'S SD IN LOT 13	0	OR209	1922
130-005-080-0	MOODY KAREN	SMITH'S SD IN LOT 12	0	OR225	3392
130-005-070-0	MOODY KAREN	SMITH'S SD IN LOT 11	0	OR225	3392
130-005-060-0	MOODY KAREN	SMITH'S SD IN LOT 10	0	OR225	3392
130-005-050-0	MOODY KAREN	SMITH'S SD IN LOT 9	0	OR225	3392
130-004-980-0	MOODY KAREN S	SMITH'S SD IN LOT 8	0	OR213	2151
130-004-970-0	MOODY KAREN S	SMITH'S SD IN LOT 7	0	OR213	2151
130-005-090-0	VANOSTER JOHN G & EMILY R	SMITH'S SD IN LOT 6 SURVIVO	0	OR187	425
130-005-100-0	VANOSTER JOHN G & EMILY R	SMITH'S SD IN LOT 5 SURVIVO	0	OR187	425
130-005-020-0	STATE OF OHIO, DEPARTMENT OF TRANSP	SMITH'S SD IN LOT 3	0	OR233	467
130-005-000-0	STATE OF OHIO, DEPARTMENT OF TRANSP	SMITH'S SD IN LOT 2	0	OR233	471
130-004-990-0	STATE OF OHIO, DEPARTMENT OF TRANSP	SMITH'S SD IN LOT 1	0	OR233	471
130-005-010-0	STATE OF OHIO, DEPARTMENT OF TRANSP	SMITH'S SD IN LOT 4	0	OR233	467

Disclaimer: The information that these maps contains is for reference purposes only.  
Please bring any errors to the attention of the Engineer's Office staff. Thank you

Source: Morgan County Engineer's Office  
DATE: 12/20/2022

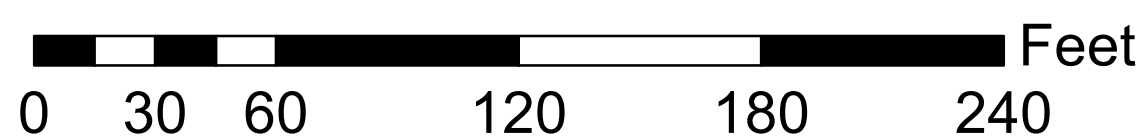

Boundaries			
	Hydro		Section
	Roads		Lot
	County		Township
	Parcel		ROW